

MAY 22, 2008  
SCALE: 1"=30'

IRON PINS TO BE SET  
AT ALL LOT CORNERS, AT  
COMPLETION OF CONSTRUCTION

NOTE:

POSITIONAL ACCURACY OF FOUNDATION POINTS VS.  
FIELD TIED FOUNDATION POINTS ARE EQUAL TO OR  
LESS THAN DISTANCES SHOWN IN PARENTHESIS.

NOTE:

OWNER RESERVES A NON-EXCLUSIVE PERPETUAL  
BLANKET GENERAL UTILITY EASEMENT OVER  
AND THROUGH THE PROPERTY FOR INGRESS, EGRESS,  
INSTALLATION AND UPKEEP OF EQUIPMENT FOR  
PROVIDING TO ANY PORTION OF THE PROPERTY OR  
ADJACENT REAL ESTATE, ANY UTILITIES,  
WHETHER PUBLIC OR PRIVATE.

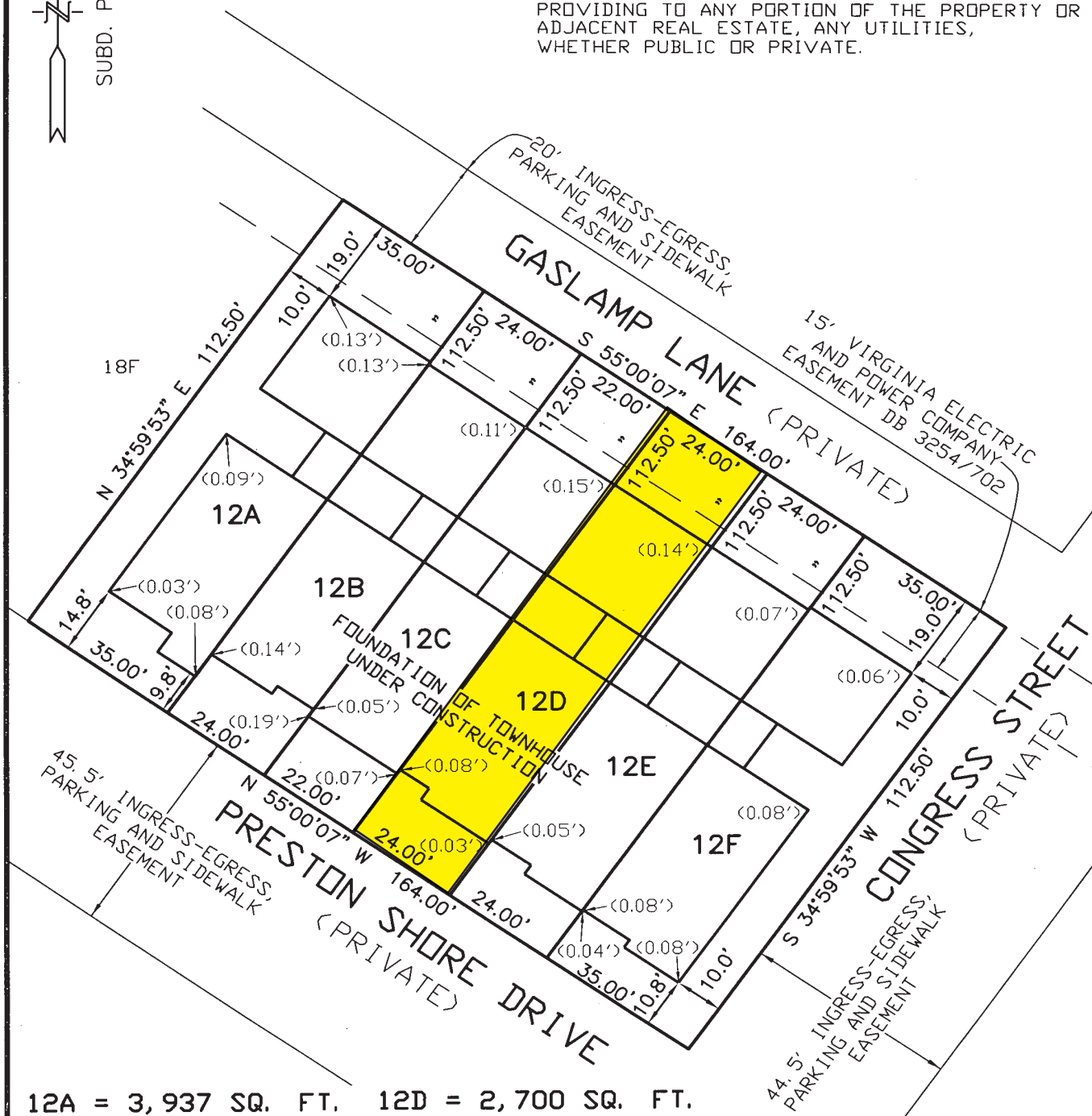

12A = 3,937 SQ. FT.	12D = 2,700 SQ. FT.
12B = 2,700 SQ. FT.	12E = 2,700 SQ. FT.
12C = 2,475 SQ. FT.	12F = 3,938 SQ. FT.

# WALL CHECK ON LOTS 12A-12F, PRESTON LAKE, SECTION 1

CENTRAL DISTRICT, ROCKINGHAM COUNTY, VIRGINIA

**BENNER & ASSOC., INC.**  
8 PLEASANT HILL ROAD  
HARRISONBURG, VA 22801  
540 434-0267  
REF# 011405-T12  
DRAWING: 011405-T12.DWG

